

**HUNT MIDWEST SUBTROPOLIS
 DATA CENTER**
 UNDERGROUND DRIVE,
 KANSAS CITY, MISSOURI

JOB NO: 30-08-5613
 DATE: 04/03/2009
 DRAWN BY: JRR
 CHECKED BY: JC
 SUBMISSION: PRELIMINARY
 REVISIONS:

PHASE 1

LEGEND:

- PHASE 1
- PHASE 2
- INFRASTRUCTURE CORRIDOR
- SETBACK AREA
- SHALE

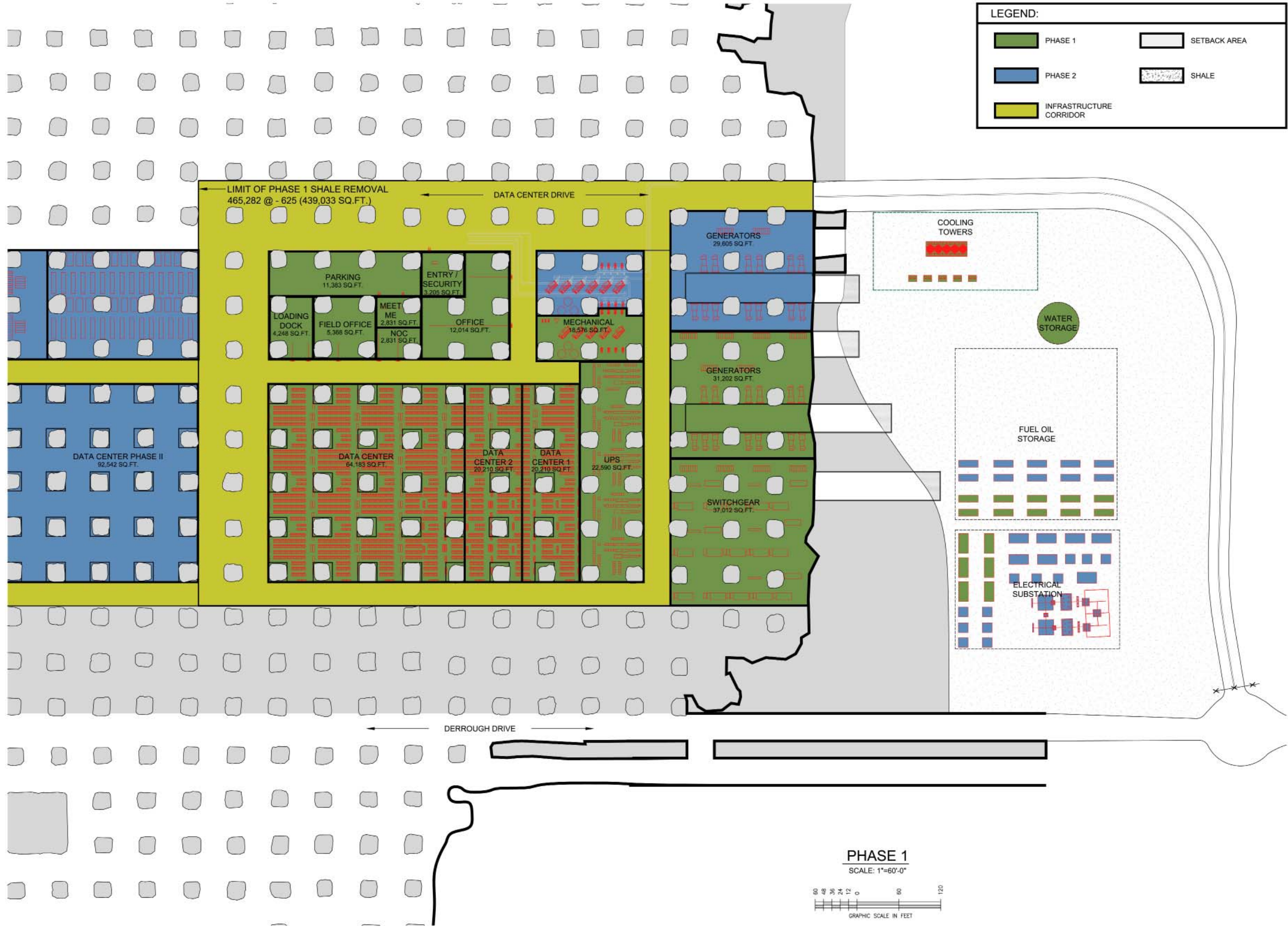

LIMIT OF PHASE 1 SHALE REMOVAL
 465,282 @ - 625 (439,033 SQ.FT.)

DATA CENTER DRIVE

DERROUGH DRIVE

PARKING 11,363 SQ.FT.

LOADING DOCK 4,248 SQ.FT.

FIELD OFFICE 5,368 SQ.FT.

MEET ME 2,831 SQ.FT.

NOC 2,831 SQ.FT.

OFFICE 12,014 SQ.FT.

MECHANICAL 38,576 SQ.FT.

DATA CENTER 64,183 SQ.FT.

DATA CENTER 2 20,210 SQ.FT.

DATA CENTER 1 20,210 SQ.FT.

UPS 22,590 SQ.FT.

GENERATORS 29,605 SQ.FT.

GENERATORS 31,202 SQ.FT.

SWITCHGEAR 37,012 SQ.FT.

COOLING TOWERS

WATER STORAGE

FUEL OIL STORAGE

ELECTRICAL SUBSTATION

DATA CENTER PHASE II
 92,542 SQ.FT.